

# Power Factor Correction Systems

**Product:** Capacitor Based Power Factor Unit.  
Rapid Rearbus System

**Description:** Up to 300kVAR, Capacitor Based 7 step unit,  
Standard Rearbus connection, which makes it easier to hot-swap trays.

**Major Part Vendor:** Rittal, KBR, Elektra & Noark

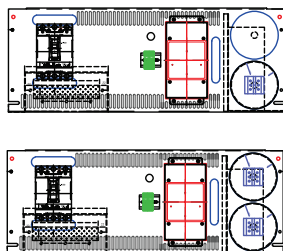
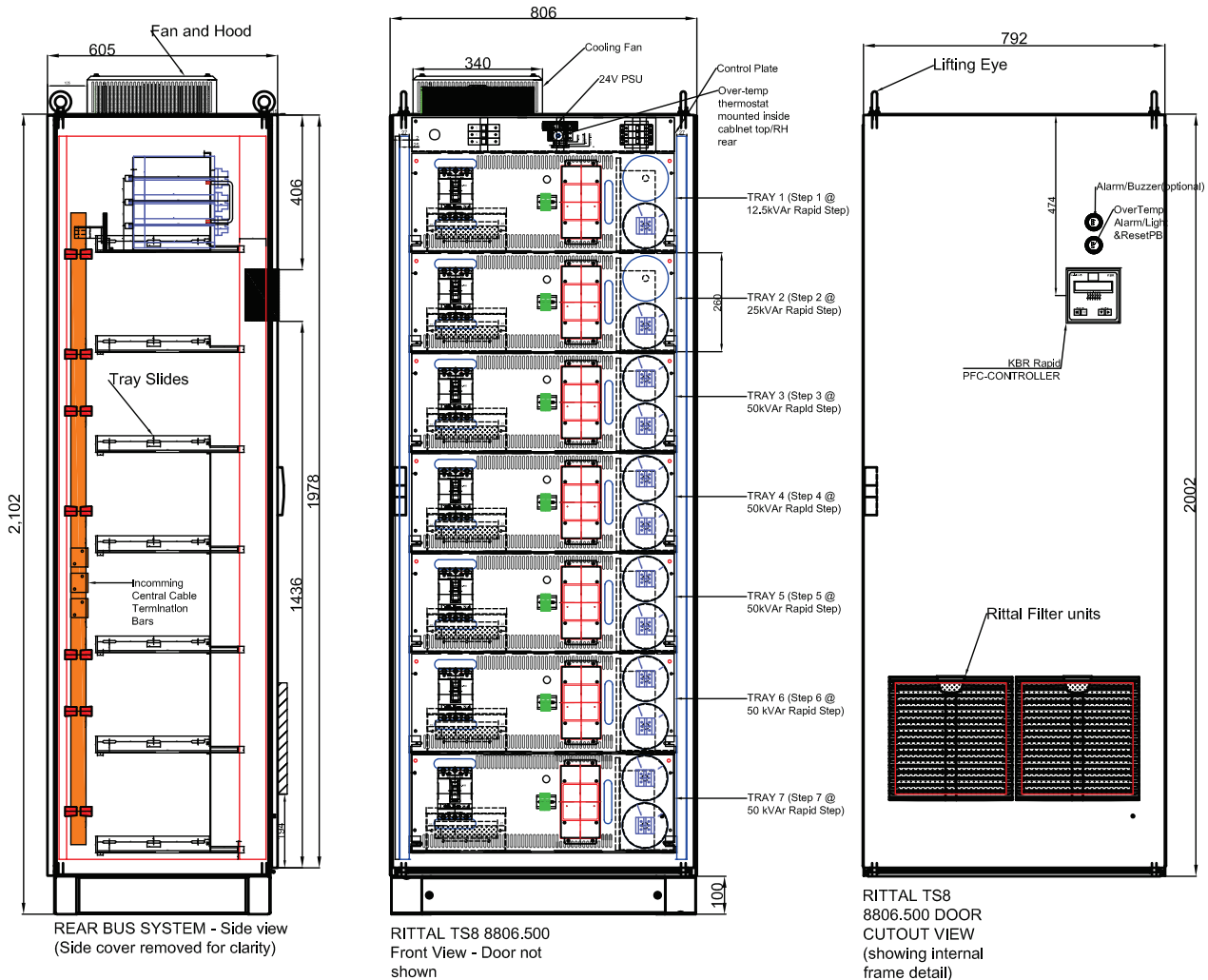

- RAPID TRAY SYSTEM**
- KBR Thyro Switch
  - NOARC MCCB to suit step size
  - Elektra Harmonic Blocking Reactor (187Hz)
  - KBR Capacitors

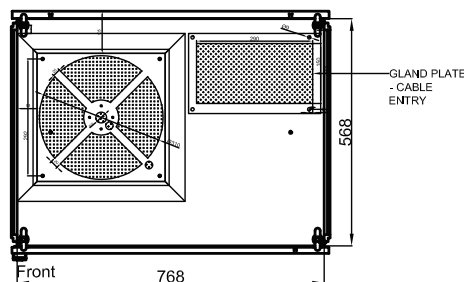

REAR BUS SYSTEM - Top View

## **General:**

---

**Installed Cabinet Dimensions:** 2,202H x 792W x 578D

**Weight:** 500kg+

**Operating Temperatures:** 65°C

**Housing:** Powdercoated mild steel (Rittal)

**Warranty:** 2 years components, 5 years workmanship

## **System Parameters:**

---

**Nominal Current:** 1.35x kVAR Rating

**Rated Voltage:** 415V

**Power Frequency:** 50Hz

**Protective Device for Supply:** 1.5x nominal current

## **Overall Performance & Mechanical:**

---

**Contactor:** NOARK - rated for tray size

**Control:** Thyroswitch KBR - 24VDC Controlled

**Reactor:** Elektra - tuned at 187Hz

**Leading or Lagging:** Lagging

**Switching Speed:** 20mS

**Monitoring Capabilities:** Modbus Communication

**Cooling System:** Thermostat Controlled

**Over temperature Protection:** Thermostat Controlled

## **Tray (Step) Performance & Mechanical**

---

**Net Weight per Tray:** 60kg~

**Rated Voltage:** 415/440

**Hot Swappable:** True

**kVAR Ratings Available:** 6.25, 12.5, 17, 25, 33, 50

